

## **Request for Quote – SBE Subcontractors and Suppliers**

Project: CSAH 10 Pavement Reclamation & Culvert  
CP 2181400 & 2180800, SAP 027-610-033  
Hennepin County

Bid Date: Tuesday, November 2, 2021

Bid Time: 2:00 pm

SBE Goal: 21%

C.S. McCrossan Construction, Inc. is soliciting quotations from qualified bidders to develop pricing for the above referenced project. Please see the attached sheet for a list of potential work types that are available on this project.

C.S. McCrossan Construction, Inc. is an Equal Opportunity Employer and encourages participation from all certified SBE subcontractors and suppliers. If you can provide us with pricing in any of the areas listed above please return the attached form to our office. Plans are available for free in our online plan room; please contact us for more information.

If you need any assistance in the following areas, please contact our office:

1. Locating plans
2. Bonding, insurance, lines of credit
3. Technical assistance in preparing your quote
4. Breaking down work types into more economically feasible units
5. Locating equipment & supplies to prepare your quote

Thank you,

CSM Estimating Department

[estimating@mccrossan.com](mailto:estimating@mccrossan.com)

763-425-4167 (p) | 763-488-1649 (f)

We have identified the following work types for this project:

Project: CSAH 10 Pavement Reclamation & Culvert  
CP 2181400 & 2180800, SAP 027-610-033  
Hennepin County

Aggregates	Asphalt Paving
Box Culvert	Bridges/Structures
Clearing & Grubbing	Dewatering
Dumpsters	Erosion Control
Excavation/Grading	Fencing
Milling	Portable Restrooms
Reclamation	Removals
Riprap/Geotextiles	Sawcutting
Seed Sod & Turf Est.	Signing
Striping	Structure Excavation/Backfill
Sweeping	Traffic Control
Trucking	Underground Pipe/Structures

This list is of the work types we have determined as of this time. Additional work types may be determined as we continue to review the plans and specifications. If you are interested in bidding on this project but do not see your type of work listed, please contact our office to see if additional opportunities may be available.

## REQUEST FOR QUOTE

### RESPONSE FORM

C.S. McCrossan Construction, Inc. is bidding the following upcoming project. Potential Bidders are requested to check the appropriate box below and let us know of their intentions by email ([estimating@mccrossan.com](mailto:estimating@mccrossan.com)) or fax (763-488-1649).

**Project****Interest**

Yes

No

CSAH 10 Reclamation  
Hennepin County

**Name of Firm:**

---

**Contact Person:**

---

Phone / Fax Number:

---

Email:

---

**Type of Work:**

(Please list work types you are  
interested in quoting.)

---

---

---

---

**Assistance Needed:**

(Please list any assistance we  
can provide you in preparing  
your quote.)

---

---

---

---

C.S. McCrossan Construction, Inc. is an Equal Opportunity Employer and encourages participation from all certified SBE subcontractors and suppliers. If you are interested in providing us a quote please return this form to our office via email ([estimating@mccrossan.com](mailto:estimating@mccrossan.com)) or by fax (763-488-1649).

If you need assistance or any additional information (plans / specifications), please contact our office.

MINNESOTA DEPARTMENT OF TRANSPORTATION

HENNEPIN COUNTY TRANSPORTATION DEPARTMENT

CONSTRUCTION PLAN FOR: COLD INPLACE RECYCLING, PAVEMENT REMOVAL AND STRIPING, REMOVAL OF BOX CULVERT BRIDGE #90462, INSTALLATION OF (2) BOX CULVERTS, MISC. CULVERTS, GRADING, BITUMINOUS PAVEMENT, & TURF ESTABLISHMENT

COUNTY STATE AID HIGHWAY NO. 10

CITY OF CORCORAN

CP 1814 LOCATION: CSAH 10 AT S FORK RUSH CRK CP 1808 LOCATION: CSAH 10 E OF BURSCHVILLE TO W OF CORCORAN

GROSS LENGTH	325.00 FEET	0.062 MILES	GROSS LENGTH	24,775.00 FEET	4.692 MILES
BRIDGE LENGTH	N/A FEET	N/A MILES	BRIDGE LENGTH	N/A FEET	N/A MILES
EXCEPTION LENGTH	N/A FEET	N/A MILES	EXCEPTION LENGTH	N/A FEET	N/A MILES
NET LENGTH	325.00 FEET	0.062 MILES	NET LENGTH	24775.00 FEET	4.692 MILES

GOVERNING SPECIFICATIONS

THE 2018 EDITION OF THE MINNESOTA DEPARTMENT OF TRANSPORTATION "STANDARD SPECIFICATIONS FOR HIGHWAY CONSTRUCTION", AND ALL SUPPLEMENTS THERETO, SHALL GOVERN. ALL TRAFFIC CONTROL DEVICES SHALL CONFORM AND BE INSTALLED IN ACCORDANCE TO THE MOST RECENT EDITION OF THE "MINNESOTA MANUAL ON UNIFORM TRAFFIC CONTROL DEVICES INCLUDING "FIELD MANUAL FOR TEMPORARY TRAFFIC CONTROL ZONE LAYOUTS".

SHEET NO.	INDEX DESCRIPTION
1	TITLE SHEET
2-3	STATEMENT OF ESTIMATED QUANTITIES
4	SOILS NOTES, STD. PLANS/PLATES, AND EARTHWORK
5	TYPICAL SECTION
6-22	CONSTRUCTION SHEETS
SS1-SS25	PERMANENT SIGNING AND STRIPING
TC1-TC3	TRAFFIC CONTROL
C1	CULVERT TITLE, 1814 SEQ, PAGE INDEX
C2	TYPICAL SECTIONS
C3	UTILITY LAYOUT
C4	ROAD ALIGNMENT AND PROFILE
C5	REMOVAL PLAN
C6	CONSTRUCTION PLAN
C7	CULVERT PROFILES
C8-C11	MNDOT STANDARD PLANS (CULVERT)
C12	EROSION CONTROL
C13	STILLING BASIN (RIPRAP DETAIL)
C14	WATER RESOURCES
C15-C18	CROSS SECTIONS

THIS PLAN CONTAINS 68 SHEETS

APPROVED	.....	DATE
	HENNEPIN COUNTY: COUNTY HIGHWAY ENGINEER	
RECOMMENDED FOR APPROVAL	.....	DATE
	HENNEPIN COUNTY: BRIDGE DIVISION ENGINEER	
APPROVED	.....	DATE
	CITY OF CORCORAN ENGINEER	
	.....	DATE
	DISTRICT STATE AID ENGINEER: REVIEWED FOR COMPLIANCE WITH STATE AID RULES/POLICY	
	.....	DATE
	APPROVED FOR STATE AID FUNDING: STATE AID ENGINEER	

PLAN SYMBOLS

COUNTY LINE	---
SECTION LINE	----
QUARTER LINE	-----
SIXTEENTH LINE	-----
NEW RIGHT OF WAY LINE	-----
PRESENT RIGHT OF WAY LINE	-----
PROPERTY LINE (EXCEPT LAND LINES)	-----
VACATED PLATTED PROPERTY	-----
CORPORATE OR CITY LIMITS	-----
TRUNK HIGHWAY CENTER LINE	-----
RETAINING WALL	-----
RAILROAD	-----
WATER LINE	-----
MEANDER CORNER	-----
DRAINAGE DITCH	-----
DRAIN TILE	-----
CULVERT	-----
GUARD RAIL	-----
BARBED WIRE FENCE	-----
CHAIN LINK FENCE	-----
STONE WALL OR FENCE	-----
HEDGE	-----
RAILROAD CROSSING SIGN	-----
MARSH	-----
WOODS	-----
ORCHARD	-----
BRUSH	-----
NURSERY	-----
CATCH BASIN	-----
FIRE HYDRANT	-----
OVERPASS (HIGHWAY OVER)	-----
UNDERPASS (HIGHWAY UNDER)	-----
BRIDGE	-----
BUILDING	-----
IRON PIPE OR ROD	-----
MONUMENT (STONE, CONCRETE OR METAL)	-----
SMALL SIGN	-----
CONSTRUCTION ZONE LINE	-----

UTILITY SYMBOLS

POWER POLE	-----
TELEPHONE POLE	-----
ANCHOR	-----
STEEL TOWER	-----
STREET LIGHT	-----
TELEVISION CABLE RISER	-----
WATER MAIN	-----
CONDUIT	-----
TELEPHONE CABLE IN CONDUIT	-----
ELECTRIC CABLE IN CONDUIT	-----
TELEPHONE MANHOLE	-----
ELECTRIC MANHOLE	-----
BURIED TELEPHONE CABLE	-----
BURIED ELECTRIC CABLE	-----
STORM SEWER	-----
SEWER MANHOLE	-----
SANITARY SEWER	-----
GAS MAIN	-----
TELEVISION CABLE	-----
FIBER OPTIC	-----

PROJECTS ARE LOCATED WITHIN THE FOLLOWING LAND SECTION:  
T 119 N, R 23 W SECTIONS:  
7, 8, 15, 16, 17, 18, 22, 23

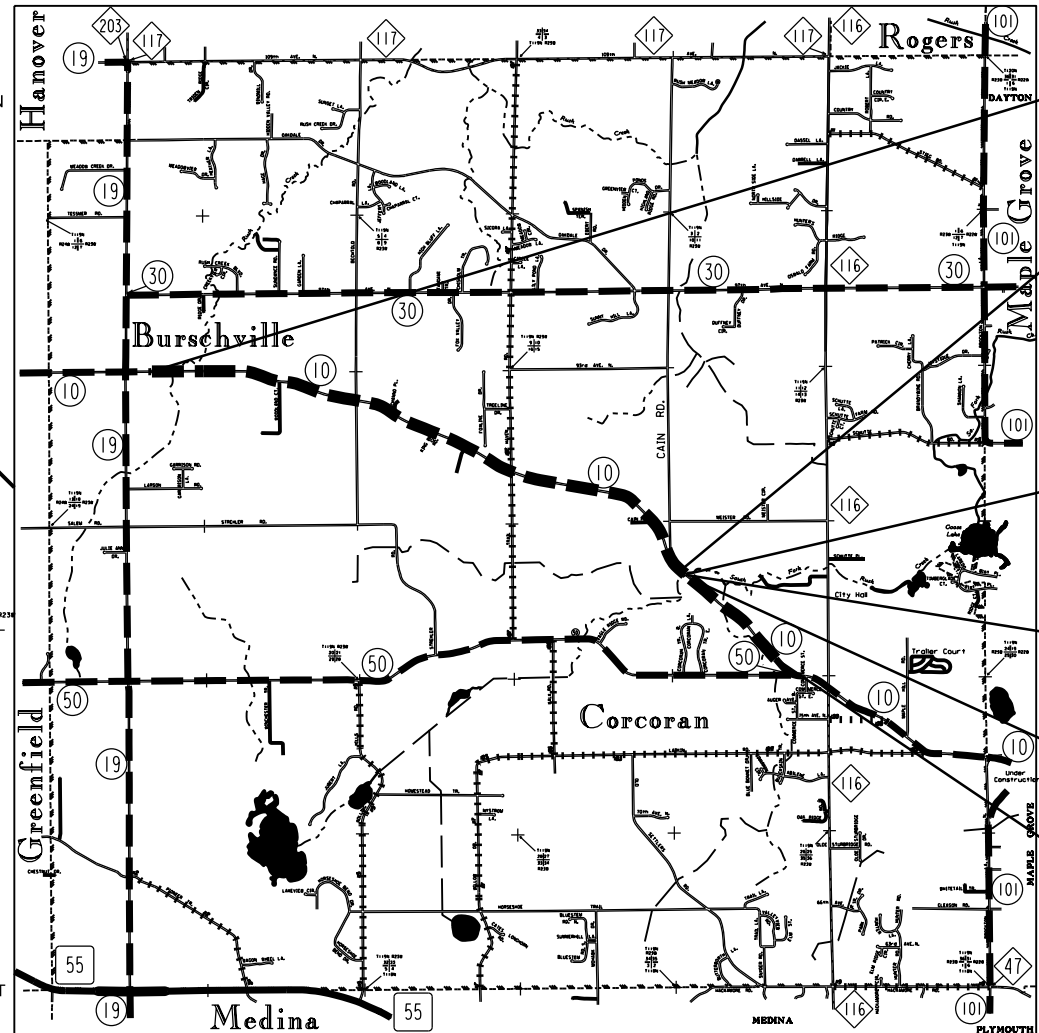
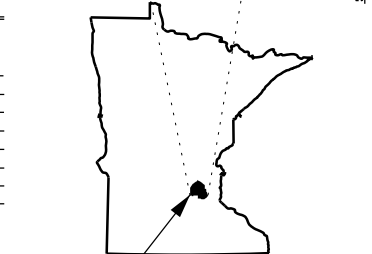
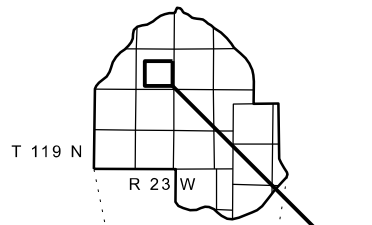

DESIGN DESIGNATION

ADT (CURRENT YEAR) 2022	= 2,900	∑ N18 (20)	340,000
ADT (DESIGN YEAR) 2042	= 4,200	DESIGN SPEED	50 MPH
DHV (DESIGN HR. VOL.)	= N/A	BASED ON	STOPPING SIGHT DISTANCE
D (DIRECTIONAL DISTR.)	= N/A	HEIGHT OF EYE	3.5'
T (HEAVY COMMERCIAL)	= 3.9%	HEIGHT OF OBJECT	2.0'
R VALUE	= 12	FUNCTIONAL CLASS	MAJOR COLLECTOR
10 TON DESIGN LOAD		NO. OF TRAFFIC LANES	2
		NO. OF PARKING LANES	0
		SHOULDER WIDTH	6.0'

THE SUBSURFACE UTILITY INFORMATION IN THIS PLAN IS UTILITY QUALITY LEVEL D. THIS QUALITY LEVEL WAS DETERMINED ACCORDING TO GUIDELINES OF CI/ASCE 38-02 ENTITLED "STANDARD GUIDELINES FOR THE COLLECTION AND DEPICTION OF EXISTING SUBSURFACE UTILITY DATA."

SCALES

CULVERT PLAN	1" = 30'
CIR & STRIPING PLAN	1" = 50'
INDEX MAP	1" = 6500'
GENERAL LAYOUT	NONE
CULVERT PROFILE	60' HORIZ. 6' VERT.



I HEREBY CERTIFY THAT THIS PLAN WAS PREPARED BY ME OR UNDER MY DIRECT SUPERVISION AND THAT I AM A DULY LICENSED PROFESSIONAL ENGINEER UNDER THE LAWS OF THE STATE OF MINNESOTA.

*Joshua D. Potter*  
JOSHUA D. POTTER, LICENSED PROFESSIONAL ENGINEER

53094 10/01/2021  
LICENSE NO. DATE

DESIGN SQUAD

J. SCHERER S. MANKE N. LOCKE  
A. TROMBLEY R. WIDMER D. KUNATH

TITLE SHEET

CSAH 10 COLD INPLACE RECYCLING / HENNEPIN COUNTY PROJECT 1808  
CSAH 10 / HENNEPIN COUNTY PROJECT 1814 SAP 027-610-033

SHEET

1  
22

Reference Number	Type	Description	Unit Of Measure	Quantity	Group Label	Order
2016.601/00053	Base	QUALITY MANAGEMENT - THERMAL PROFILING	LUMP SUM	1	Default Item Group	1
2016.601/00054	Base	QUALITY MANAGEMENT - INTELLIGENT COMPACTION	LUMP SUM	1	Default Item Group	2
2021.501/00010	Base	MOBILIZATION	LUMP SUM	1	Default Item Group	3
2101.501/00020	Base	CLEARING & GRUBBING	LUMP SUM	1	Default Item Group	4
2104.502/00090	Base	REMOVE BOX CULVERT	EACH	1	Default Item Group	5
2104.502/01240	Base	REMOVE SIGN TYPE C	EACH	20	Default Item Group	6
2104.502/01690	Base	REMOVE SIGN PANEL TYPE C	EACH	1	Default Item Group	7
2104.502/01910	Base	REMOVE ENERGY ABSORBING TERMINAL	EACH	4	Default Item Group	8
2104.503/00205	Base	SAWING BIT PAVEMENT (FULL DEPTH)	LIN FT	60	Default Item Group	9
2104.503/00255	Base	REMOVE PIPE CULVERTS	LIN FT	36	Default Item Group	10
2104.503/00440	Base	REMOVE GUARDRAIL	LIN FT	335	Default Item Group	11
2104.503/00750	Base	REMOVE BARBED WIRE FENCE	LIN FT	191	Default Item Group	12
2104.503/01280	Base	SALVAGE WOODEN FENCE	LIN FT	308	Default Item Group	13
2104.504/00120	Base	REMOVE BITUMINOUS PAVEMENT	SQ YD	1,033.00	Default Item Group	14
2105.504/00035	Base	GEOTEXTILE FABRIC TYPE 5	SQ YD	805	Default Item Group	15
2105.601/00045	Base	TEMPORARY STREAM DIVERSION SYSTEM	LUMP SUM	1	Default Item Group	16
2105.607/00420	Base	EXCAVATION SPECIAL	CU YD	300	Default Item Group	17
2106.507/00010	Base	EXCAVATION - COMMON	CU YD	936	Default Item Group	18
2106.507/00040	Base	EXCAVATION - SUBGRADE	CU YD	746	Default Item Group	19
2106.507/00080	Base	SELECT GRANULAR EMBANKMENT (CV)	CU YD	1,365.00	Default Item Group	20
2106.507/00130	Base	COMMON EMBANKMENT (CV)	CU YD	997	Default Item Group	21
2118.509/00030	Base	AGGREGATE SURFACING CLASS 2	TON	1,392.00	Default Item Group	22
2123.610/00410	Base	STREET SWEEPER (WITH PICKUP BROOM)	HOUR	15	Default Item Group	23
2130.523/00010	Base	WATER	M GALLON	5	Default Item Group	24
2211.507/00170	Base	AGGREGATE BASE (CV) CLASS 5	CU YD	330	Default Item Group	25
2211.509/00070	Base	AGGREGATE BASE CLASS 5	TON	400	Default Item Group	26
2215.509/00010	Base	BITUMINOUS MATERIAL FOR MIXTURE	TON	242	Default Item Group	27
2215.509/00020	Base	CEMENT	TON	61	Default Item Group	28
2231.509/00010	Base	BITUMINOUS PATCHING MIXTURE	TON	40	Default Item Group	29
2231.509/00030	Base	BITUMINOUS PATCHING MIXTURE (SPECIAL)	TON	150	Default Item Group	30
2232.504/00020	Base	MILL BITUMINOUS SURFACE (1.0")	SQ YD	86,146.00	Default Item Group	31
2355.506/00010	Base	BITUMINOUS MATERIAL FOR FOG SEAL	GALLON	6,924.00	Default Item Group	32
2360.509/13200	Base	TYPE SP 9.5 WEARING COURSE MIX (3;B)	TON	14,328.00	Default Item Group	33
2390.504/00010	Base	COLD-IN-PLACE RECYCLED / CCPR BITUMINOUS	SQ YD	69,241.00	Default Item Group	34
2401.601/00010	Base	STRUCTURE EXCAVATION	LUMP SUM	1	Default Item Group	35
2412.502/06040	Base	6X4 PRECAST CONCRETE BOX CULV END SECT	EACH	2	Default Item Group	36
2412.502/06060	Base	6X6 PRECAST CONCRETE BOX CULV END SECT	EACH	2	Default Item Group	37
2412.503/06040	Base	6X4 PRECAST CONCRETE BOX CULVERT	LIN FT	86	Default Item Group	38
2412.503/06060	Base	6X6 PRECAST CONCRETE BOX CULVERT	LIN FT	86	Default Item Group	39
2451.507/00190	Base	COARSE FILTER AGGREGATE (CV)	CU YD	205	Default Item Group	40
2501.502/23024	Base	24" CS SAFETY APR & GRATE DES 3128	EACH	2	Default Item Group	41
2501.502/45080	Base	INSTALL CULVERT MARKER	EACH	6	Default Item Group	42
2501.503/12024	Base	24" CS PIPE CULVERT	LIN FT	78	Default Item Group	43
2501.603/26015	Base	15" PIPE CULVERT	LIN FT	36	Default Item Group	44
2511.507/00014	Base	RANDOM RIPRAP CLASS III	CU YD	67	Default Item Group	45
2533.503/03010	Base	PORTABLE PRECAST CONC BARRIER DES 8337	LIN FT	80	Default Item Group	46
2533.503/03030	Base	RELOCATE PORT PRECAST CONC BAR DES 8337	LIN FT	80	Default Item Group	47
2557.503/01523	Base	WIRE FENCE DESIGN 60V-9322	LIN FT	112	Default Item Group	48
2557.603/11055	Base	INSTALL WOODEN FENCE	LIN FT	300	Default Item Group	49
2563.601/00001	Base	TRAFFIC CONTROL SUPERVISOR	LUMP SUM	1	Default Item Group	50
2563.601/00010	Base	TRAFFIC CONTROL	LUMP SUM	1	Default Item Group	51
2563.613/01100	Base	PORTABLE CHANGEABLE MESSAGE SIGN	UNIT DAY	112	Default Item Group	52
2563.618/00011	Base	CONSTRUCTION SIGN-SPECIAL	SQ FT	80	Default Item Group	53
2564.518/00130	Base	SIGN PANELS TYPE C	SQ FT	55	Default Item Group	54
2572.503/00020	Base	TEMPORARY FENCE	LIN FT	300	Default Item Group	55
2573.501/00030	Base	EROSION CONTROL SUPERVISOR	LUMP SUM	1	Default Item Group	56
2573.503/00020	Base	SILT FENCE; TYPE HI	LIN FT	220	Default Item Group	57
2573.503/00023	Base	SILT FENCE; TYPE MS	LIN FT	576	Default Item Group	58
2573.503/00031	Base	FLOTATION SILT CURTAIN TYPE MOVING WATER	LIN FT	85	Default Item Group	59
2573.503/00061	Base	SEDIMENT CONTROL LOG TYPE WOOD FIBER	LIN FT	50	Default Item Group	60
2574.505/00010	Base	SUBSOILING	ACRE	0.5	Default Item Group	61
2574.505/00020	Base	SOIL BED PREPARATION	ACRE	0.5	Default Item Group	62
2574.507/00106	Base	ORGANIC TOPSOIL BORROW	CU YD	30	Default Item Group	63
2574.508/00012	Base	FERTILIZER TYPE 2	POUND	95	Default Item Group	64
2575.501/00020	Base	TURF ESTABLISHMENT	LUMP SUM	1	Default Item Group	65

2575.505/00021	Base SEEDING	ACRE	0.5 Default Item Group	66
2575.508/25131	Base SEED MIXTURE 25-131	POUND	105 Default Item Group	67
2575.508/40001	Base HYDRAULIC MULCH MATRIX	POUND	960 Default Item Group	68
2575.523/00010	Base WATER	M GALLON	2 Default Item Group	69
2575.523/00020	Base RAPID STABILIZATION METHOD 3	M GALLON	4 Default Item Group	70
2582.503/10104	Base 4" SOLID LINE PAINT	LIN FT	22,044.00 Default Item Group	71
2582.503/10106	Base 6" SOLID LINE PAINT	LIN FT	97,754.00 Default Item Group	72
2582.503/10124	Base 24" SOLID LINE PAINT	LIN FT	532 Default Item Group	73
2582.503/10204	Base 4" BROKEN LINE PAINT	LIN FT	7,360.00 Default Item Group	74
2582.503/10304	Base 4" DOTTED LINE PAINT	LIN FT	220 Default Item Group	75
2582.503/10404	Base 4" DBLE SOLID LINE PAINT	LIN FT	18,850.00 Default Item Group	76
2582.503/36104	Base 4" SOLID LINE MULTI COMP GR IN	LIN FT	11,022.00 Default Item Group	77
2582.503/36106	Base 6" SOLID LINE MULTI COMP GR IN	LIN FT	48,877.00 Default Item Group	78
2582.503/36124	Base 24" SOLID LINE MULTI COMP GR IN	LIN FT	266 Default Item Group	79
2582.503/36204	Base 4" BROKEN LINE MULTI COMP GR IN	LIN FT	3,680.00 Default Item Group	80
2582.503/36304	Base 4" DOTTED LINE MULTI COMP GR IN	LIN FT	110 Default Item Group	81
2582.503/36404	Base 4" DBLE SOLID LINE MULTI COMP GR IN	LIN FT	9,425.00 Default Item Group	82
2582.518/04020	Base PAVT MSSG PREF THERMO GR IN	SQ FT	60 Default Item Group	83